

Ejector pins with DLC coating

Productivity increase through solid, high-precision products

Do you have problems with adhesion or corrosion? Do rust marks appear on the ejector or wear caused by exhaust gases? DME has the solution!

With a DLC (Diamond-like-carbon) coating of our ejector pins you will obtain a clear increase in productivity. This amorphous carbon layer has a very high inherent hardness and an extremely low friction coefficient. Thanks to the optimal dry-running properties, greasing the ejector pins becomes unnecessary. The result is an end product which does not discolour and has a longer life.



Characteristics and advantages

- Excellent tribological properties
- Extreme resistance against wear caused by adhesion
- Superb corrosion resistance
- Low costs of tools and machinery that are not in use
- No discolouration in the end product
- Optimal dry-running properties
- Maximum increase of the product life

Technical information

Base material: hardened tool steel and HSS
 Layer hardness: 2,000-3,000 HV
 Layer strength: 2-3µm
 Coating temp.: approx. 180°C
 Layer colour: black-grey

DLC coating: 2.5 µm -
 with a hardness of 2,000 - 3,000 HV

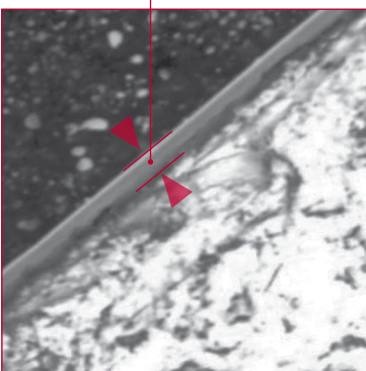

Coating	Friction coefficients against steel
TiN	0.4
CrN	0.25
DLC	0.1 - 0.15

Please bear in mind that the diameter, determined by the layer structure, may have a positive tolerance for the µ value.

Type DLC - with DLC coating

Information

according to DIN ISO 6751 (DIN 1530 Part 1, Type AH, hardened); DLC coated

Some other dimensions or intermediate dimensions available from stock.
Prices on request.

Item price in euros

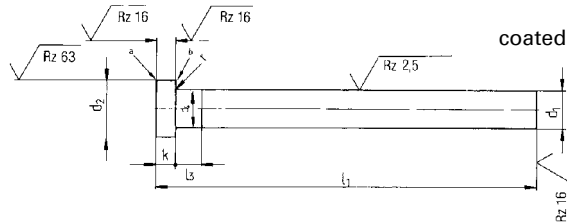

a = edge free of burr / b = rounded edge
a = edge free of burr / b = rounded edge



REF	Diameter d1 g6 +coating	d2 0 -0,2	d4	k 0 -0,05	r +0,2 0	E-shop prices € Length				l3
						100	160	250	315	
AH-DLC	1,0	2,5	d1+0,03	1,2	0,2	9,90	14,89	-		10
AH-DLC	1,2					10,00	15,03	-		
AH-DLC	1,5	3		1,5		6,79	8,69	14,36		
AH-DLC	1,8					10,91	14,87	-		
AH-DLC	2,0	4		2,0		5,91	7,82	12,69		
AH-DLC	2,2					-	8,13	-		
AH-DLC	2,5	5		3,0	0,3	5,91	7,82	12,69		
AH-DLC	3,0	6				5,91	7,82	12,69		
AH-DLC	3,2	7				6,59	8,26	14,22		
AH-DLC	3,5					6,28	8,13	13,93		
AH-DLC	3,7	6,71				8,46	14,50			
AH-DLC	4,0	8				6,19	8,06	13,80		
AH-DLC	4,2		7,09		9,10	14,87				
AH-DLC	4,5	10	6,79		8,81	15,66				
AH-DLC	4,7		7,22		9,26	15,14				
AH-DLC	5,0	6,79	8,74		15,66	18,88				
AH-DLC	5,2	12	8,23		10,60	17,53				
AH-DLC	5,5		8,01		10,28	17,06				
AH-DLC	6,0	14	5,0	0,5	7,86	10,23	17,06			
AH-DLC	6,2				9,34	13,23	24,48			
AH-DLC	6,5				9,05	12,86	23,76	-		
AH-DLC	7,0				9,05	12,86	23,76			
AH-DLC	8,0	16	7,0	0,8	8,74	12,75	20,72			
AH-DLC	8,2				13,13	17,70	30,54			
AH-DLC	8,5	12,75			17,19	29,69				
AH-DLC	10,0	12,74			17,30	28,17	31,76			
AH-DLC	12,0	18			16,09	22,50	33,94			